

## TECHNICIAN CHECKLIST FOR INSTALLATION OF THE SUPERFY PRO FILL LEVEL SENSOR

Please read the provided [Installation Guide](#) for a step by step instructions on best practices to Installing the Superfy Pro Fill Level Sensor.

- The completed installation checklist should be returned by email to Superfy ([support@superfy.com](mailto:support@superfy.com)) for our records.
- Photos of each installation must be added to the Superfy Platform/Mobile Application for each sensor (please refer to the installation guide for more details).
- Improper installation is the major cause of performance related issues and warranty breaches.

**Note:** It is imperative that sensors are installed correctly and the checklist is completed and returned in full to Superfy. Failure to do so could affect the performance of the sensor, void the warranty and may require on-site support which Superfy would have to charge for.

Customer Name: \_\_\_\_\_ Sensor Serial Number: \_\_\_\_\_

Installation Location: \_\_\_\_\_

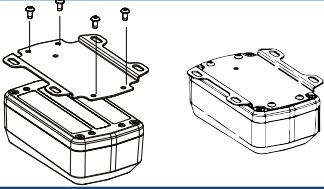
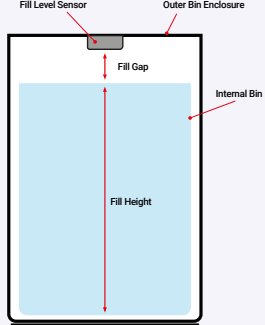
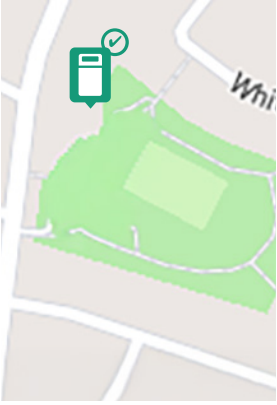
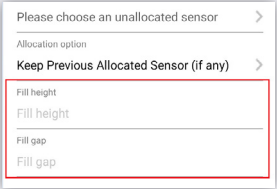
		Yes	No
1.	I have reviewed the Superfy Superfy Pro Installation Guide and understand the steps needed to install the Superfy Pro Sensor.		
2.	I have installed and logged into the Superfy Mobile Application as per the Installation Guide. → <a href="#">Download the Superfy Mobile Application</a>   → <a href="#">Log into the Superfy Mobile Application</a>		
3.	I have installed the Bracket on the sensor as per the Installation Guide (if Applicable). 		
4.	I have taken a Fill Height and Fill Gap Measurements of the Containers as per the Installation Guide using a laser pointer or other measuring device. Note the measurements, and prepare to enter this information in the Superfy Mobile Application. → <a href="#">How to take a Fill Height and Fill Gap Measurement</a> 		
5.	I have assigned each sensor to its corresponding Container on the Superfy Mobile Application as per the Installation Guide. <b>Note:</b> Once you log in to the Superfy mobile Application, you'll see green pins (📍) with a tick mark indicating the exact containers and locations that require sensor installation. If the Containers have not been added to the map before installation, make sure to add them while on site. → <a href="#">Adding a Container to the Platform</a> <b>Note:</b> Tap the <b>Centre</b> button at the bottom of the Superfy app to center the map on your current GPS location. → <a href="#">Attach a Sensor to a Specific Container</a> <b>Note:</b> Once the sensor is attached to each container, the icon will appear grey if the sensor is turned off. When the sensor is turned on, the icons will change to green, orange, or red, depending on the first distance reading detected. 		
6.	I have added the Fill Height and Fill Gap Measurements to each Container as per the Installation Guide. 		

7.

I have **Turned On** the sensors using an appropriate magnet and I have heard the correct sequence of beeps to indicate the device is ON (*sensor is advised to be activated right before installation as per the Installation Guide*).

→ [How to Power On a Superfy Pro Fill Level Sensor](#)

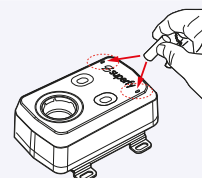

8.

I confirm that the sensor is securely fixed to the container and that the optical lasers are pointed directly to the centre of the bottom of the container.

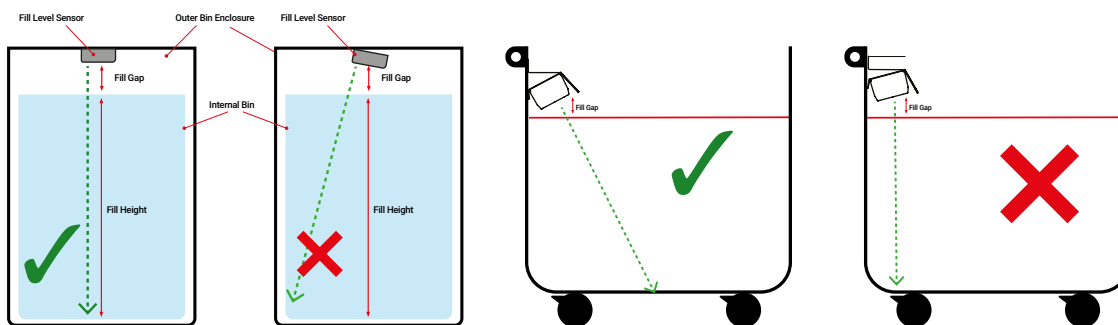

9.

I have taken pictures of each of the sensor installation and added them to each individual container on the Superfy Mobile Application as per the Installation Guide (this includes a clear picture of where and how the sensors are installed in the container (multiple angle, picture of the fitting), surroundings of the container and container type).



10.

I can confirm that I have conducted a manual reading as per the Installation Guide and each sensor is reporting accurate Fill Level percentage reading.

**Note:** To conduct a manual reading, simply turn the sensor off and then back on.

→ [How to take a manual reading in the App](#)

11.

## VERIFYING CORRECT INSTALLATION

I have verified, in the Superfy Mobile Application, the Container Icon has changed from **GREY** ( ) to a **Green** ( ), **Orange** ( ), or **Red** ( ) colour depending on the Fill Level percentage. I have checked, by looking into the bin, that the displayed fullness level is correct.e.g. If the App says it is <10% full then you should see the container is almost empty. If the App says it is 50% full then you should see that the container is half full. If these don't match then either the lasers cannot see the bottom of the container **OR** the fill height and gap measurements are wrong, please return to Step 5. If both verification steps are completed successfully then you can sign, date and leave the site.

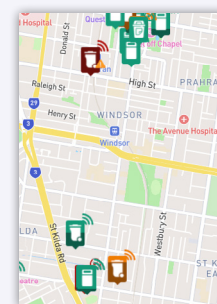

11.

Checklist Completion Date:

D	D	M	M	Y	Y	Y	Y

I confirm that I have thoroughly reviewed and checked off all items on the installation checklist. The sensors have been successfully installed, are functioning correctly, and are transmitting precise data in alignment with the provided guidelines.

Name: \_\_\_\_\_ Signature: \_\_\_\_\_